

December 2019

ONLY FOR
OKUMA

VELOCITY SU-matic®

LB45III M-Turret

www.velocityproducts.com



A Complete Lineup of In-Stock Lathe Tooling for Okuma • Three Year Warranty

VELOCITY **SU-matic**[®]

Velocity Tooling: Only for Okuma

Velocity Products has the largest inventory of lathe tooling for **Okuma** in North America. Velocity is the OEM supplier of tooling startup kits for **Okuma** lathes. Velocity tooling is designed and manufactured by SU-matic – a worldwide leader in tooling technology headquartered in Switzerland. SU-matic has several **Okuma** machine tools in their manufacturing facility. SU-matic works closely with engineers from **Okuma America**, **Okuma Japan**, and **Okuma Europe** when designing tools. This engineering collaboration ensures flawless tooling performance on **Okuma** lathes, multitasking machines, and machining centers. Velocity/SU-matic tooling is available **Only for Okuma** machine tools.

Velocity Tooling Technology

Velocity tools are delivered ready to use; all live tools are run-in at the factory and internal coolant tools are pressure tested as a final quality check prior to shipment. Velocity tools are greased for life; no customer maintenance is required. Velocity/SU-matic tools are CMM inspected and serialized records are kept on file.

Three Year Warranty

Velocity/SU-matic Tooling is designed to give years of service under the most demanding applications. The build quality of our tool holders allows us to back them with an **UNMATCHED Three Year Factory Warranty**.



VELOCITY SU-matic[®]
VELOCITYPRODUCTS.COM



Contents

VELOCITY TOOLING MATRIX • ORDER FORM	3
TOOLING KITS	5
CROSS (RADIAL) TOOLS	6
FACE (AXIAL) TOOLS	6
OD-I HOLDERS	7
OD-II HOLDER	8
BORING BAR HOLDER	8
SU-MATIC CAPTO TOOLS	9



Tool Matrix

Company _____
 Contact _____
 Address _____
 City, State, Zip _____
 E-mail _____
 Phone/Fax # _____
 Dealer Location _____

Tool
Description

LB45III M-Turret

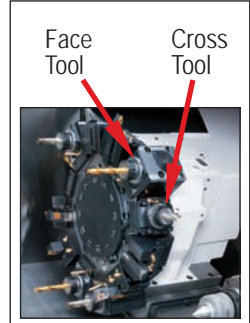



Turret Plugs

Machine Model	Part #	Quantity
LB45III M-Turret	14.430.0.0157.0	

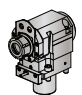
Live Tools

Tool Type	Tool #	Quantity	Page	Coolant (PSI)	Output	Ratio (In:Out)	Torque (Nm)	Maximum RPM
Cross	 14.101.0.0279.0		6	External	ER-50	1:1	200	3,500
	14.101.0.0277.0		6	IC (1,000)	ERC-50	1:1	200	3,500
Face	 14.800.0.0395.0		6	External	ER-50	1:1	200	3,500
	14.800.0.0393.0		6	IC (1,450)	ERC-50	1:1	200	3,500

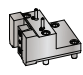
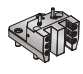
OD-I & OD-II Holders

Holder Type	Holder Style	Tool #	Quantity	Page	Stick Size (Inches)	Reversible (main/sub)	Coolant
OD-I	 OD-I	14.910.0.0347.0		7	1.25	Yes	External
	 OD-I Y-Axis	14.910.0.0423.0		7	1.25 (2)	Yes	External
OD-II	 OD-II	14.910.0.0348.0		8	1.25	Yes	External

Tool Matrix

Boring Bar Holder

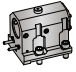
Holder Type	Holder Style	Tool #	Quantity	Page	Bar Size (Inches)	Reversible (main/sub)	Coolant
Boring Bar 	Full Depth	14.910.0.0349.0		8	2.5	-	IC & EXT

SU-matic Capto® Live Tools

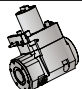
Tool Type	Tool #	Quantity	Page	Coolant (PSI)	Output	Ratio (In:Out)	Torque (Nm)	Maximum RPM
Cross 	14.101.0.0288.0		9	IC (1,015)	C5	1:1	200	3,500
Face 	14.800.0.0399.0		9	IC (1,450)	C5	1:1	200	3,500

SU-matic Capto® Static Tools

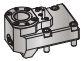
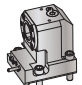
Holder Type	Holder Style	Tool #	Quantity	Page	Output	Reversible (main/sub)	Coolant
C6 OD-I 	OD-I	14.910.0.0379.0		10	C6	Yes	IC & EXT
C6 Boring Bar 	Offset	14.910.0.0380.0		10	C6	Yes	IC & EXT







VELOCITY TOOLING FOR OKUMA LB45III M-Turret

LB45III M-Turret Kits

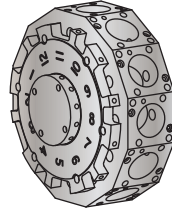

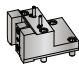
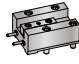
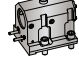
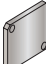
LB45III • V12 M-Turret



Description		Static Kit • M Turret	Live Tooling Kits	
Tool Type Tool Size Velocity #	Turret / Type	M	External Coolant	Internal Coolant
	Part # OAC	KUP-0153-00	KUP-0154-00	KUP-0155-00
	Part # Velocity	14.430.0.0164.0	14.430.0.0162.0	14.430.0.0163.0
OD-I 1.25" 14.910.0.0347.0		3		
OD-II 1.25" 14.910.0.0348.0		1		
ID 2.5" 14.910.0.0349.0		2		
Turret Plug 14.430.0.0157.0		6		
Cross Tool ER-50 14.101.0.0279.0			2	
Face Tool ER-50 14.800.0.0395.0			2	
Cross Tool (IC) ERC-50 14.101.0.0277.0				2
Face Tool (IC) ERC-50 14.800.0.0393.0				2

VELOCITY TOOLING FOR OKUMA LB45III M-Turret

Live Tools



LB45III M-Turret Cross Tools • ER-50 Output

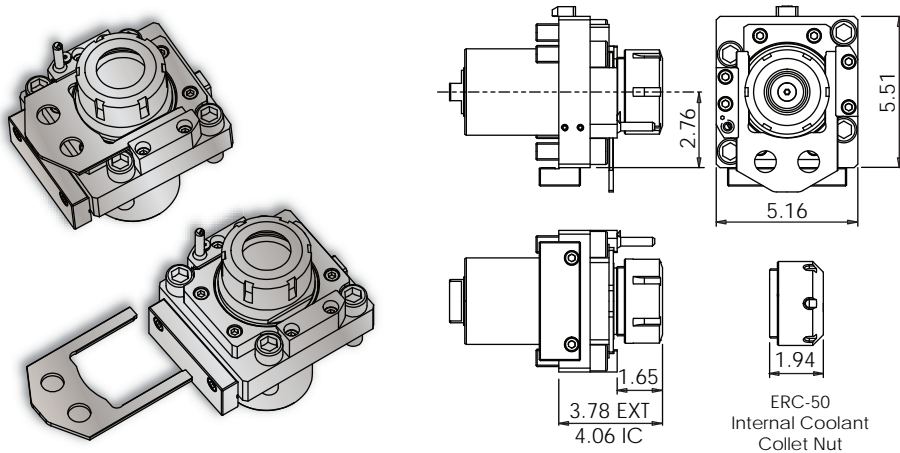

Notes			
Wrenches Included with Tools			
Maximum Drill Ø		Maximum Mill Ø	
EXT	1 3/8"	EXT	1 3/16"
IC	1 3/8"	IC	1 3/16"
Turret Plugs		14.430.0.0157.0	
* 1,000 psi internal coolant (IC) cross tool CANNOT be run without coolant.			
All coolant thru live tools require 30 micron coolant filtration nominal, 50 micron coolant filtration absolute.			

Tool #	Coolant	Output	Rotation (In:Out)	Ratio (In:Out)	Max. RPM	Torque	Spindle Wrench	Collet Wrench
14.101.0.0279.0	EXT	ER-50	CW:CW	1:1	3,500	200 Nm	1005101050	7111.50000
14.101.0.0277.0	IC & EXT* 1,000 psi	ERC-50	CW:CW	1:1	3,500	200 Nm	1005101050	7111.50000

LB45III M-Turret Face Tools • ER-50 Output

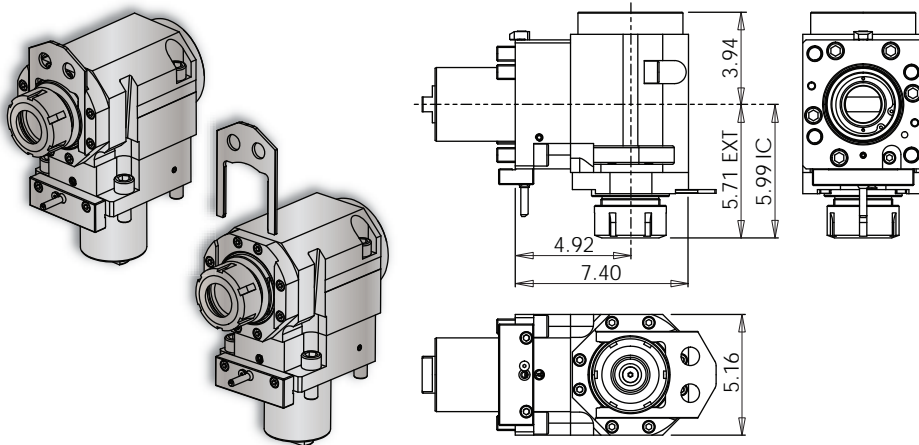

Notes			
Wrenches Included with Tools			
Maximum Drill Ø		Maximum Mill Ø	
EXT	1 3/8"	EXT	1 3/16"
IC	1 3/8"	IC	1 3/16"
Turret Plugs		14.430.0.0157.0	
* 1,450 psi internal coolant (IC) face tool CAN be run without coolant; the coolant sealing mechanism can be completely dis-engaged.			
All coolant thru live tools require 30 micron coolant filtration nominal, 50 micron coolant filtration absolute.			

Tool #	Coolant	Output	Rotation (In:Out)	Ratio (In:Out)	Max. RPM	Torque	Spindle Wrench	Collet Wrench
14.800.0.0395.0	EXT	ER-50	CW:CW	1:1	3,500	200 Nm	1005101050	7111.50000
14.800.0.0393.0	IC & EXT* 1,450 psi	ERC-50	CW:CW	1:1	3,500	200 Nm	1005101050	7111.50000

VELOCITY TOOLING FOR OKUMA LB45III M-Turret

Static Tools



LB45III M-Turret OD-I Holder

Notes

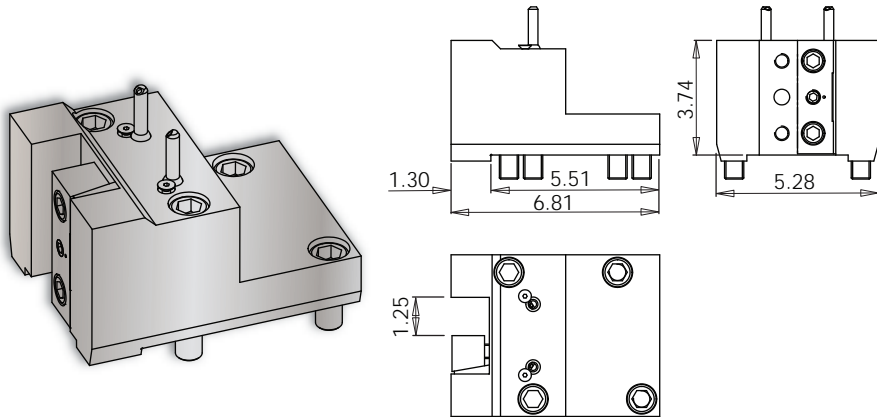

3D Models (.stp) and CAS (.stl) files are available for all **VELOCITY/SU-matic** tool holders. Please contact Velocity: sales@velocityproducts.com.

Turret Plugs	14.430.0.0157.0
--------------	-----------------

VELOCITY/SU-matic tooling for OKUMA is manufactured on OKUMA machine tools.

VELOCITY has the most complete inventory of tooling for OKUMA machine tools in North America.

Lathe Model	Tool #	Reversible (Main/Sub)	Stick Size	Depth	Height	Width
LB45III M	14.910.0.0347.0	Yes	1.25"	6.81"	3.74"	5.28"

LB45III M-Turret Y-Axis OD-I Holder

Notes

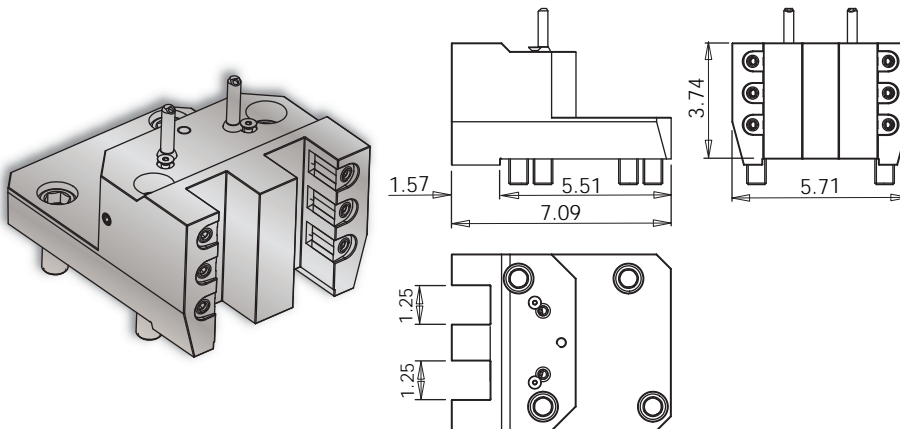

3D Models (.stp) and CAS (.stl) files are available for all **VELOCITY/SU-matic** tool holders. Please contact Velocity: sales@velocityproducts.com.

Turret Plugs	14.430.0.0157.0
--------------	-----------------

VELOCITY/SU-matic tooling for OKUMA is manufactured on OKUMA machine tools.

VELOCITY has the most complete inventory of tooling for OKUMA machine tools in North America.

Lathe Model	Tool #	Reversible (Main/Sub)	Stick Size	Depth	Height	Width
LB45III MY	14.910.0.0423.0	Yes	1.25" (2)	7.09"	3.74"	5.71"

VELOCITY TOOLING FOR OKUMA LB45III M-Turret

Static Tools



LB45III M-Turret OD-II Holder

Notes

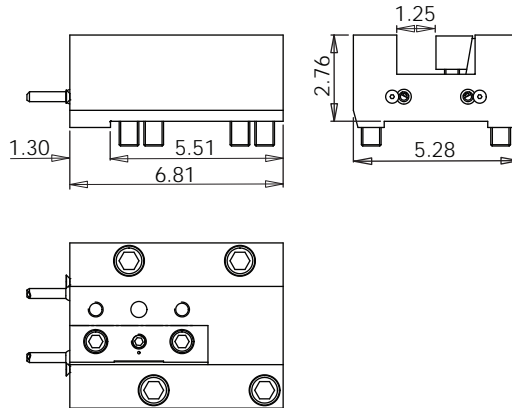
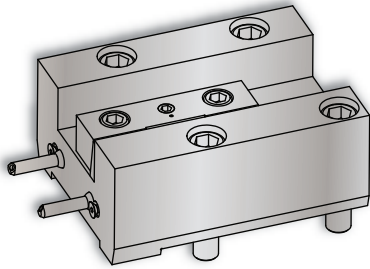

3D Models (.stp) and CAS (.stl) files are available for all *VELOCITY/SU-matic* tool holders. Please contact Velocity: sales@velocityproducts.com.

Turret Plugs	14.430.0.0157.0
--------------	-----------------

VELOCITY/SU-matic tooling for OKUMA is manufactured on OKUMA machine tools.

VELOCITY has the most complete inventory of tooling for OKUMA machine tools in North America.

Lathe Model	Tool #	Reversible (Main/Sub)	Stick Size	Depth	Height	Width
LB45III M	14.910.0.0348.0	Yes	1.25"	6.81"	2.76"	5.28"

LB45III M-Turret Boring Bar Holder

Notes

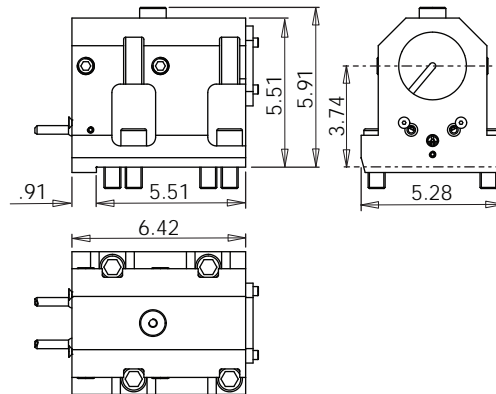
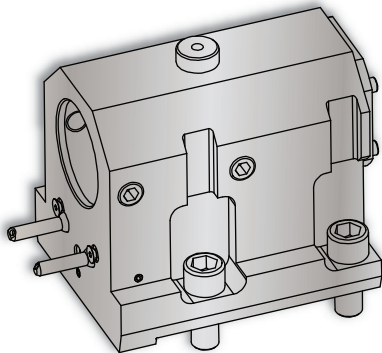

VELOCITY/SU-matic ID holders can be used with both internal and external coolant. **Internal Coolant Plates** are included with all *VELOCITY/SU-matic* multitasking turret ID holders.

Turret Plugs	14.430.0.0157.0
--------------	-----------------

VELOCITY/SU-matic tooling for OKUMA is manufactured on OKUMA machine tools.

Coolant filtration is recommended when using ID holders with internal coolant plates.

Lathe Model	Tool #	Reversible (Main/Sub)	Coolant	ID	Height	Depth
LB45III M	14.910.0.0349.0	-	IC/EXT	2.5"	5.91"	6.42"

VELOCITY TOOLING FOR OKUMA LB45III M-Turret

SU-matic Capto® Tools



LB45III M-Turret C5 Cross Tool

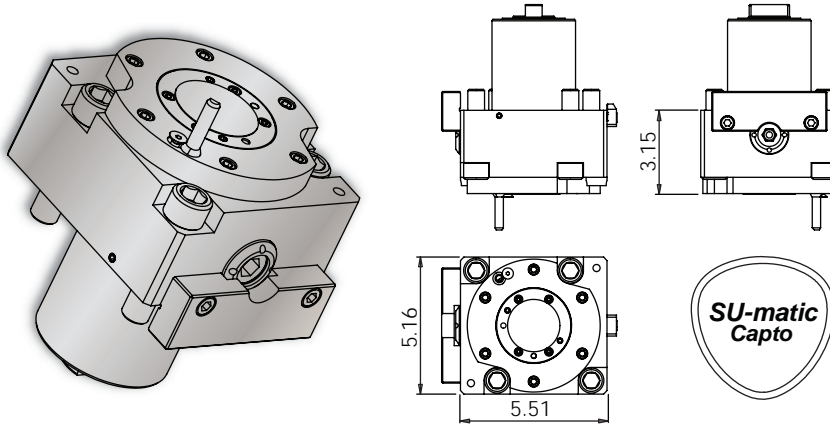

Notes

REGO-FIX® C5 Collet Chucks

ER Output	Rego-Fix Part #
ER-16	4805.11630
ER-20	4805.12010
ER-25	4805.12510
ER-32	4805.13210

Turret Plugs	14.430.0.0157.0
--------------	-----------------

* 1,000 psi internal coolant (IC) cross tool CANNOT be run without coolant.

All coolant thru live tools require 30 micron coolant filtration nominal, 50 micron coolant filtration absolute.

Tool #	Coolant	Output	Rotation (In:Out)	Ratio (In:Out)	Max. RPM	Torque	Hex Wrench	C5 Collet Chucks
14.101.0.0288.0	IC & EXT* 1,000 psi	C5	CW:CW	1:1	3,500	200 Nm	12 mm	See Above

LB45III M-Turret C5 Face Tool

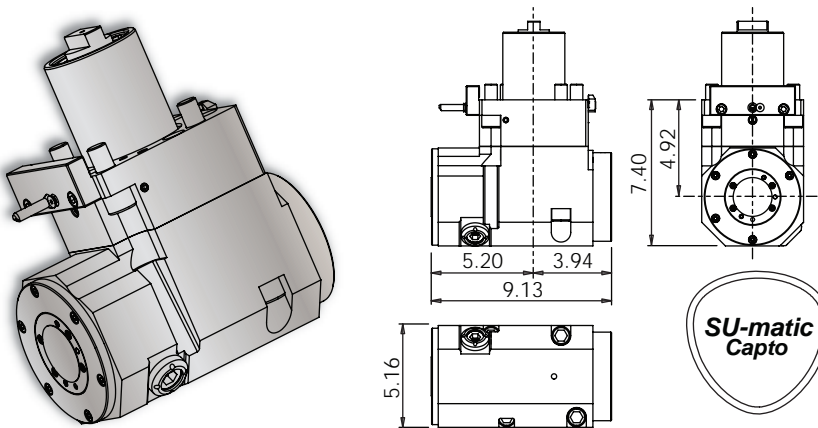

Notes

REGO-FIX® C5 Collet Chucks

ER Output	Rego-Fix Part #
ER-16	4805.11630
ER-20	4805.12010
ER-25	4805.12510
ER-32	4805.13210

Turret Plugs	14.430.0.0157.0
--------------	-----------------

* 1,450 psi internal coolant (IC) face tool CAN be run without coolant; the coolant sealing mechanism can be completely dis-engaged.

All coolant thru live tools require 30 micron coolant filtration nominal, 50 micron coolant filtration absolute.

Tool #	Coolant	Output	Rotation (In:Out)	Ratio (In:Out)	Max. RPM	Torque	Hex Wrench	C5 Collet Chucks
14.800.0.0399.0	IC & EXT* 1,450 psi	C5	CW:CW	1:1	3,500	200 Nm	12 mm	See Above

VELOCITY TOOLING FOR OKUMA LB45III M-Turret

SU-matic Capto® Tools



LB45III M-Turret C6 OD-I Holder

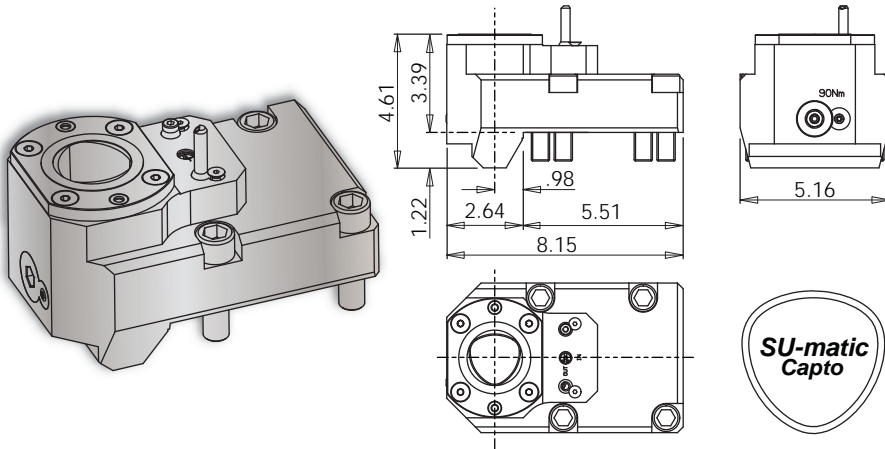

Notes

REGO-FIX® C6 Collet Chucks

ER Output	Rego-Fix Part #
ER-20	2806.12020
ER-25	2806.12520
ER-32	2806.13220
ER-40	2806.14020

Turret Plugs 14.430.0.0157.0

VELOCITY/SU-matic tooling for OKUMA is manufactured on OKUMA machine tools.

SU-matic Capto® static tools are coolant thru. Coolant filtration is recommended.

Lathe Model	Tool #	Reversible (Main/Sub)	Coolant	Output	Hex Wrench	C6 Collet Chucks
LB45III M	14.910.0.0379.0	No	IC/EXT	C6	12 mm	See Above

LB45III M-Turret C6 ID Holder

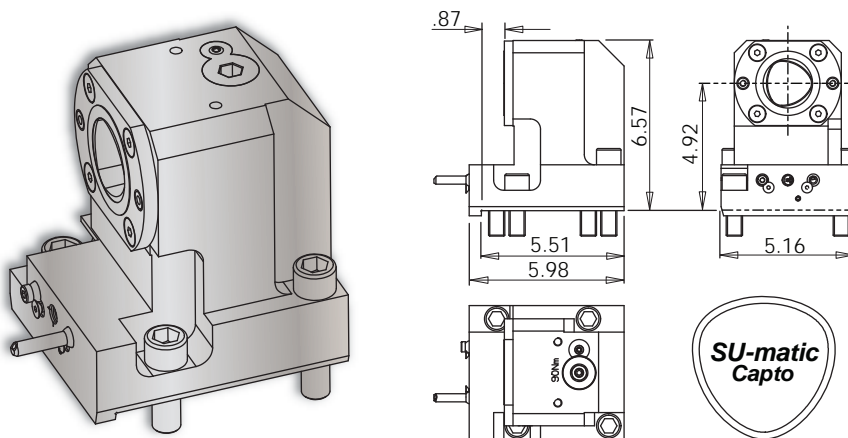

Notes

REGO-FIX® C6 Collet Chucks

ER Output	Rego-Fix Part #
ER-20	2806.12020
ER-25	2806.12520
ER-32	2806.13220
ER-40	2806.14020

Turret Plugs 14.430.0.0157.0

VELOCITY/SU-matic tooling for OKUMA is manufactured on OKUMA machine tools.

SU-matic Capto® static tools are coolant thru. Coolant filtration is recommended.

Lathe Model	Tool #	Reversible (Main/Sub)	Coolant	Output	Hex Wrench	C6 Collet Chucks
LB45III M	14.910.0.0380.0	Yes	IC/EXT	C6	12 mm	See Above

ONLY FOR
OKUMA

VELOCITY
SU-matic®

LB45III M-Turret

www.velocityproducts.com



A Complete Lineup of In-Stock Lathe Tooling for Okuma • Three Year Warranty*

Velocity Products • 350 Electronics Boulevard, Huntsville, AL 35824 • 256-258-5549
www.velocityproducts.com • sales@velocityproducts.com

*Warranty voided if internal coolant tools are used without coolant and coolant filtration. Exceeding specified maximum cutting tool sizes voids warranty.

© Velocity Products • Specifications subject to change without notice • Velocity-Okuma LB45III M-Turret 6.2018.5