

December 2019

ONLY FOR
OKUMA

VELOCITY

SU-matic®

V760/V920 • 2SP-V760/V920

www.velocityproducts.com



A Complete Lineup of In-Stock Lathe Tooling for Okuma • Three Year Warranty

VELOCITY **SU-matic**[®]

Velocity Tooling: Only for Okuma

Velocity Products has the largest inventory of lathe tooling for **Okuma** in North America. Velocity is the OEM supplier of tooling startup kits for **Okuma** lathes. Velocity tooling is designed and manufactured by SU-matic – a worldwide leader in tooling technology headquartered in Switzerland. SU-matic has several **Okuma** machine tools in their manufacturing facility. SU-matic works closely with engineers from **Okuma America**, **Okuma Japan**, and **Okuma Europe** when designing tools. This engineering collaboration ensures flawless tooling performance on **Okuma** lathes, multitasking machines, and machining centers. Velocity/SU-matic tooling is available **Only for Okuma** machine tools.

Velocity Tooling Technology

Velocity tools are delivered ready to use; all live tools are run-in at the factory and internal coolant tools are pressure tested as a final quality check prior to shipment. Velocity tools are greased for life; no customer maintenance is required. Velocity/SU-matic tools are CMM inspected and serialized records are kept on file.

Three Year Warranty

Velocity/SU-matic Tooling is designed to give years of service under the most demanding applications. The build quality of our tool holders allows us to back them with an **UNMATCHED Three Year Factory Warranty**.





Contents

TOOLING KITS • V760/2SP-V760	5
TOOLING KITS • V920/2SP-V920	6
ID HOLDERS • V760/2SP-V760 • V920/2SP-V920	7
OD-I HOLDER • V760/2SP-V760 • V920/2SP-V920	8
OD-II HOLDER • V760/2SP-V760 • V920/2SP-V920	8
OD-III HOLDER • V760/2SP-V760 • V920/2SP-V920	9
LIVE TOOLS • V760/2SP-V760	10
LIVE TOOLS • V920/2SP-V920	11
CAPTO STATIC TOOLS • V760/2SP-V760 • V920/2SP-V920	12
CAPTO LIVE TOOLS • V760/2SP-V760	13
CAPTO LIVE TOOLS • V920/2SP-V920	14



Tool Matrix

Company _____
 Contact _____
 Address _____
 City, State, Zip _____
 E-mail _____
 Phone/Fax # _____
 Dealer Location _____

Tool
Description
M-Turret

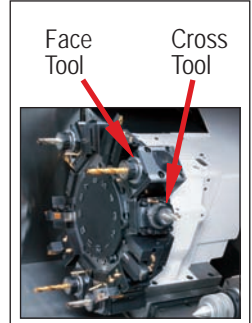

Turret Plugs

Machine Model	Part #	Quantity
V760 / 2SP-V760 M-Turret	14.430.0.0194.0	
V920 / 2SP-V920 M-Turret	14.430.0.0218.0	

V760 / 2SP-V760 • V920 / 2SP-V920 Boring Bar Holders

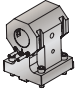

Holder Type	V-Series	Tool #	Quantity	Page	Bar Size (Inches)	Mounting Bolts	Coolant
Boring Bar Holders 	V760 V920	14.910.0.0393.0		7	2.0	M12 & M16	IC & EXT
		14.910.0.0467.1		7	2.5	M12 & M16	IC & EXT

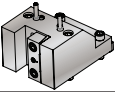
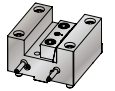
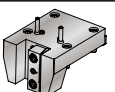
V760 / 2SP-V760 • V920 / 2SP-V920 OD-I / OD-II / OD-III Holders

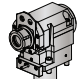

Holder Type	V-Series	Tool #	Quantity	Page	Stick Size (Inches)	Mounting Bolts	Coolant
OD-I 	V760 V920	14.910.0.0394.0		8	1.25	M12 & M16	External
OD-II 	V760 V920	14.910.0.0395.0		8	1.25	M12 & M16	External
OD-III 	V760 V920	14.910.0.0396.0		9	1.25	M12 & M16	External

Tool Matrix

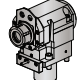

V760 /2SP-V760 • V920 / 2SP-V920 Live Tools

Tool Type		Tool #	Quantity	Page	Coolant (PSI)	Output	Mounting Bolts	Torque (Nm)	Maximum RPM
V760	Cross 	14.101.0.0310.1		10	External	ER-40	M12 M16	85	4,000
		14.101.0.0309.1		10	IC (1,000)	ERC-40	M12 M16	85	4,000
	Face 	14.800.0.0417.1		10	External	ER-40	M12 M16	85	4,000
		14.800.0.0416.1		10	IC (1,450)	ERC-40	M12 M16	85	4,000
V920	Cross 	14.101.0.0375.0		11	External	ER-50	M16	100	4,000
		14.101.0.0374.0		11	IC (1,000)	ERC-50	M16	100	4,000
	Face 	14.800.0.0479.0		11	External	ER-50	M16	100	4,000
		14.800.0.0478.0		11	IC (1,450)	ERC-50	M16	100	4,000

SU-matic Capto® Static Tools • V760 /2SP-V760 • V920 / 2SP-V920

Holder Type	V-Series	Tool #	Quantity	Page	Output	Mounting Bolts	Coolant
C6 OD-I 	V760 V920	14.910.0.0415.1		12	C6	M12 & M16	IC & EXT
C6 ID 	V760 V920	14.910.0.0416.1		12	C6	M12 & M16	IC & EXT

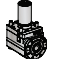
SU-matic Capto® Live Tools • V760 /2SP-V760 • V920 / 2SP-V920

Tool Type		Tool #	Quantity	Page	Coolant (PSI)	Output	Mounting Bolts	Torque (Nm)	Maximum RPM
V760	Cross 	14.101.0.0376.1		13	IC (1,000)	C5	M12 M16	85	4,000
	Face 	14.800.0.0490.1		13	IC (1,450)	C5	M12 M16	85	4,000
V920	Cross 	14.101.0.0378.0		14	IC (1,000)	C5	M16	100	4,000
	Face 	14.800.0.0488.0		14	IC (1,450)	C5	M16	100	4,000

VELOCITY TOOLING FOR OKUMA V760/V920•2SP-V760/V920

V760 / 2SP-V760 Tooling Kits



V760 / 2SP-V760 (12) Position L-Turret

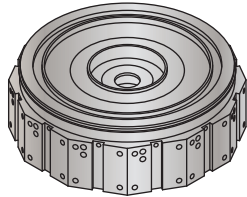

V760 / 2SP-V760 (12) Position M-Turret

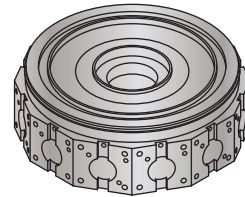

Description		Static Kits • L Turret		Static Kits • M Turret		Live Tooling Kits	
Tool Type Tool Size Velocity #	Turret / Type	V760 L	2SP-V760 L	V760 M	2SP-V760 M	External Coolant	Internal Coolant
	Part # OAC	KUP-1058-00	KUP-1059-00	KUP-1084-00	KUP-1087-00	KUP-1085-00	KUP-1086-00
	Part # Velocity	14.430.0.0168.0	14.430.0.0174.0	14.430.0.0196.0	14.430.0.0197.0	14.430.0.0182.0	14.430.0.0181.0
OD-I 1.25" 14.910.0.0394.0		3	6	3	6		
OD-II 1.25" 14.910.0.0395.0		1	2	1	2		
OD-III 1.25" 14.910.0.0396.0		1	2	1	2		
ID 2" 14.910.0.0393.0		5	10	2	4		
Cross Tool (EXT) ER-40 14.101.0.0310.1						2	
Face Tool (EXT) ER-40 14.800.0.0417.1						2	
Cross Tool (IC) ERC-40 14.101.0.0309.1							2
Face Tool (IC) ERC-40 14.800.0.0416.1							2

VELOCITY TOOLING FOR OKUMA V760/V920•2SP-V760/V920

V920 / 2SP-V920 Tooling Kits



V920 / 2SP-V920 (12) Position L-Turret

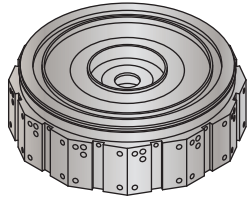

V920 / 2SP-V920 (12) Position M-Turret

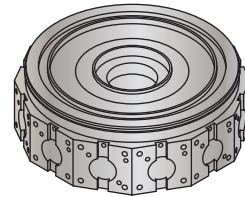

Description		Static Kits • L Turret		Static Kits • M Turret		Live Tooling Kits	
Tool Type Tool Size Velocity #	Turret / Type	V920 L	2SP-V920 L	V920 M	2SP-V920 M	External Coolant	Internal Coolant
	Part # OAC	KUP-1058-00	KUP-1059-00	KUP-1080-00	KUP-1181-00	KUP-1177-00	KUP-1178-00
	Part # Velocity	14.430.0.0168.0	14.430.0.0174.0	14.430.0.0220.0	14.430.0.0221.0	14.430.0.0216.0	14.430.0.0217.0
OD-I 1.25" 14.910.0.0394.0		3	6	3	6		
OD-II 1.25" 14.910.0.0395.0		1	2	1	2		
OD-III 1.25" 14.910.0.0396.0		1	2	1	2		
ID 2" 14.910.0.0393.0		5	10	2	4		
Cross Tool (EXT) ER-50 14.101.0.0375.0						2	
Face Tool (EXT) ER-50 14.800.0.0479.0						2	
Cross Tool (IC) ERC-50 14.101.0.0374.0							2
Face Tool (IC) ERC-50 14.800.0.0478.0							2

VELOCITY TOOLING FOR OKUMA V760/V920 • 2SP-V760/V920

V760/V920 2SP-V760/V920 Tools



V760 / V920 • 2SP-V760 / 2SP-V920 2.0" Boring Bar Holder

Notes

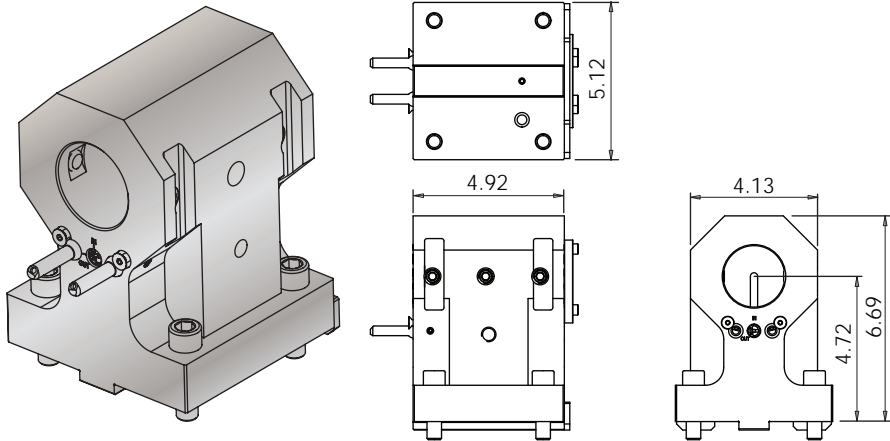

VELOCITY/SU-matic ID holders can be used with both internal and external coolant.
Internal Coolant Plates are included with all *VELOCITY/SU-matic* multitasking turret ID holders.

V760 Turret Plugs	14.430.0.0194.0
-------------------	-----------------

V920 Turret Plugs	14.430.0.0218.0
-------------------	-----------------

VELOCITY/SU-matic tooling for OKUMA is manufactured on OKUMA machine tools.

Coolant filtration is recommended when using ID holders with internal coolant plates.

Tool #	Coolant	ID	Mounting Bolt Centers	Mounting Bolts
14.910.0.0393.0	IC/EXT	2.0"	90mm x 100mm	Ships with both M12 and M16 mounting bolts

V760 / V920 • 2SP-V760 / 2SP-V920 2.5" Boring Bar Holder

Notes

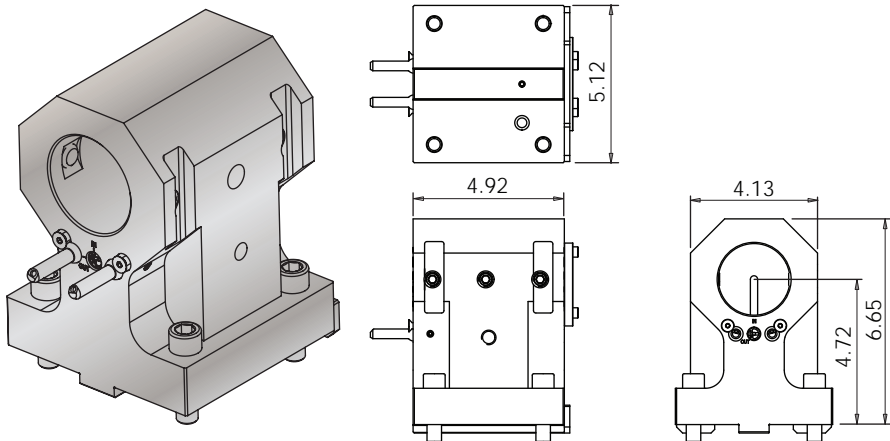

VELOCITY/SU-matic ID holders can be used with both internal and external coolant.
Internal Coolant Plates are included with all *VELOCITY/SU-matic* multitasking turret ID holders.

V760 Turret Plugs	14.430.0.0194.0
-------------------	-----------------

V920 Turret Plugs	14.430.0.0218.0
-------------------	-----------------

VELOCITY/SU-matic tooling for OKUMA is manufactured on OKUMA machine tools.

Coolant filtration is recommended when using ID holders with internal coolant plates.

VELOCITY TOOLING FOR OKUMA V760/V920 • 2SP-V760/V920

V760/V920 2SP-V760/V920 Tools



V760 / V920 • 2SP-V760 / 2SP-V920 OD-I Holder				Notes				
				3D Models (.stp) and CAS (.stl) files are available for all <i>VELOCITY/SU-matic</i> tool holders. Please contact Velocity: sales@velocityproducts.com .				
				<table border="1"> <tr> <td>V760 Turret Plugs</td> <td>14.430.0.0194.0</td> </tr> <tr> <td>V920 Turret Plugs</td> <td>14.430.0.0218.0</td> </tr> </table>	V760 Turret Plugs	14.430.0.0194.0	V920 Turret Plugs	14.430.0.0218.0
				V760 Turret Plugs	14.430.0.0194.0			
V920 Turret Plugs	14.430.0.0218.0							
<p><i>VELOCITY/SU-matic</i> tooling for OKUMA is manufactured on OKUMA machine tools.</p> <p><i>VELOCITY</i> has the most complete inventory of tooling for OKUMA machine tools in North America.</p>								
Tool #	Coolant	Stick Size	Mounting Bolt Centers	Mounting Bolts				
14.910.0.0394.0	EXT	1.25"	90mm x 100mm	Ships with both M12 and M16 mounting bolts				

V760 / V920 • 2SP-V760 / 2SP-V920 OD-II Holder				Notes				
				3D Models (.stp) and CAS (.stl) files are available for all <i>VELOCITY/SU-matic</i> tool holders. Please contact Velocity: sales@velocityproducts.com .				
				<table border="1"> <tr> <td>V760 Turret Plugs</td> <td>14.430.0.0194.0</td> </tr> <tr> <td>V920 Turret Plugs</td> <td>14.430.0.0218.0</td> </tr> </table>	V760 Turret Plugs	14.430.0.0194.0	V920 Turret Plugs	14.430.0.0218.0
				V760 Turret Plugs	14.430.0.0194.0			
V920 Turret Plugs	14.430.0.0218.0							
<p><i>VELOCITY/SU-matic</i> tooling for OKUMA is manufactured on OKUMA machine tools.</p> <p><i>VELOCITY</i> has the most complete inventory of tooling for OKUMA machine tools in North America.</p>								
Tool #	Coolant	Stick Size	Mounting Bolt Centers	Mounting Bolts				
14.910.0.0395.0	EXT	1.25"	90mm x 100mm	Ships with both M12 and M16 mounting bolts				

VELOCITY TOOLING FOR OKUMA V760/V920 • 2SP-V760/V920

V760/V920 2SP-V760/V920 Tools



V760 / V920 • 2SP-V760 / 2SP-V920 OD-III Holder

Notes

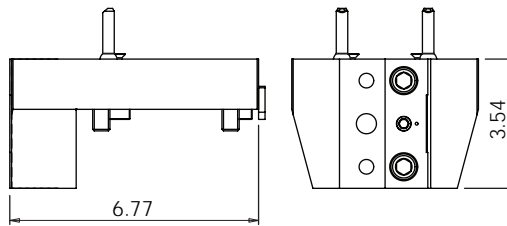
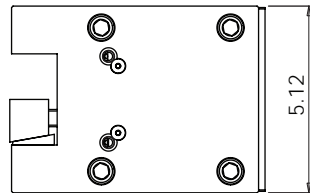
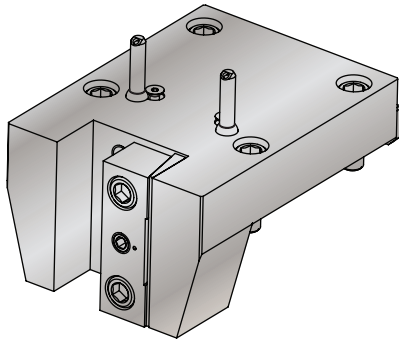

3D Models (.stp) and CAS (.stl) files are available for all *VELOCITY/SU-matic* tool holders. Please contact Velocity: sales@velocityproducts.com.

V760 Turret Plugs	14.430.0.0194.0
-------------------	-----------------

V920 Turret Plugs	14.430.0.0218.0
-------------------	-----------------

VELOCITY/SU-matic tooling for OKUMA is manufactured on OKUMA machine tools.

VELOCITY has the most complete inventory of tooling for OKUMA machine tools in North America.

Tool #	Coolant	Stick Size	Mounting Bolt Centers	Mounting Bolts
14.910.0.0396.0	EXT	1.25"	90mm x 100mm	Ships with both M12 and M16 mounting bolts



VELOCITY TOOLING FOR OKUMA V760/V920•2SP-V760/V920

V760/2SP-V760 Live Tools



V760 / 2SP-V760 Cross Tools • ER-40 Output

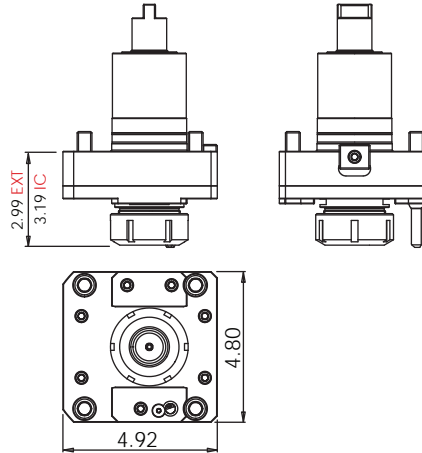
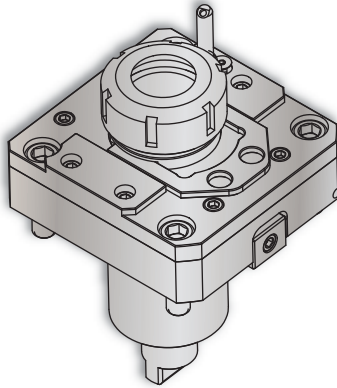

Notes

Wrenches Included with Tools

Maximum Drill Ø		Maximum Mill Ø	
EXT	1"	EXT	15/16"
IC	1"	IC	15/16"

V760 Turret Plugs 14.430.0.0194.0

* 1,000 psi internal coolant (IC) cross tool **CANNOT** be run without coolant.

All coolant thru live tools require 30 micron coolant filtration nominal, 50 micron coolant filtration absolute.

Tool #	Coolant	Output	Rotation (In:Out)	Mounting Bolts	Max. RPM	Torque	Spindle Wrench	Collet Wrench
14.101.0.0310.1	EXT	ER-40	CW:CW	M12 & M16	4,000	85 Nm	1005100980	7111.40000
14.101.0.0309.1	IC & EXT* 1,000 psi	ERC-40	CW:CW	M12 & M16	4,000	85 Nm	1005100980	7111.40000

V760 / 2SP-V760 Face Tools • ER-40 Output

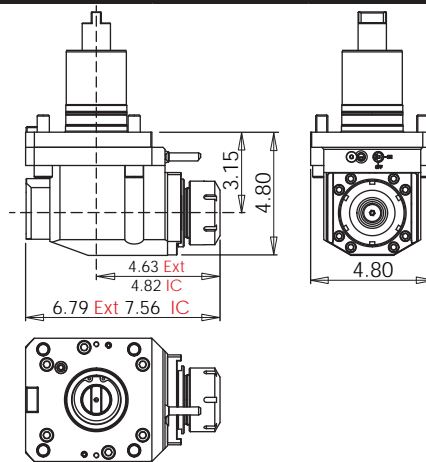
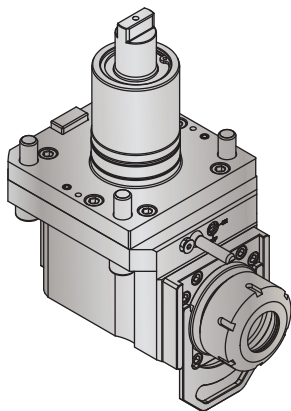

Notes

Wrenches Included with Tools

Maximum Drill Ø		Maximum Mill Ø	
EXT	1"	EXT	15/16"
IC	1"	IC	15/16"

V760 Turret Plugs 14.430.0.0194.0

* 1,450 psi internal coolant (IC) face tool **CAN** be run without coolant; the coolant sealing mechanism can be completely dis-engaged.

All coolant thru live tools require 30 micron coolant filtration nominal, 50 micron coolant filtration absolute.

Tool #	Coolant	Output	Rotation (In:Out)	Mounting Bolts	Max. RPM	Torque	Spindle Wrench	Collet Wrench
14.800.0.0417.1	EXT	ER-40	CW:CW	M12 & M16	4,000	85 Nm	1005101120	7111.40000
14.800.0.0416.1	IC & EXT* 1,450 psi	ERC-40	CW:CW	M12 & M16	4,000	85 Nm	1005101120	7111.40000

VELOCITY TOOLING FOR OKUMA V760/V920•2SP-V760/V920

V920/2SP-V920 Live Tools



V920 / 2SP-V920 Cross Tools • ER-50 Output

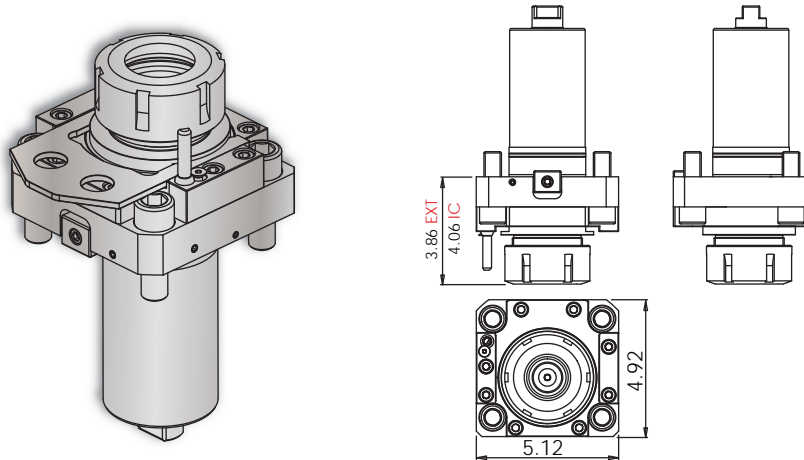

Notes

Wrenches Included with Tools

Maximum Drill Ø		Maximum Mill Ø	
EXT	1 3/8"	EXT	1 3/16"
IC	1 3/8"	IC	1 3/16"

V920 Turret Plugs 14.430.0.0218.0

* 1,000 psi internal coolant (IC) cross tool **CANNOT** be run without coolant.

All coolant thru live tools require 30 micron coolant filtration nominal, 50 micron coolant filtration absolute.

Tool #	Coolant	Output	Rotation (In:Out)	Mounting Bolts	Max. RPM	Torque	Spindle Wrench	Collet Wrench
14.101.0.0375.0	EXT	ER-50	CW:CW	M16	4,000	100 Nm	1005101050	7111.50000
14.101.0.0374.0	IC & EXT* 1,000 psi	ERC-50	CW:CW	M16	4,000	100 Nm	1005101050	7111.50000

V920 / 2SP-V920 Face Tools • ER-50 Output

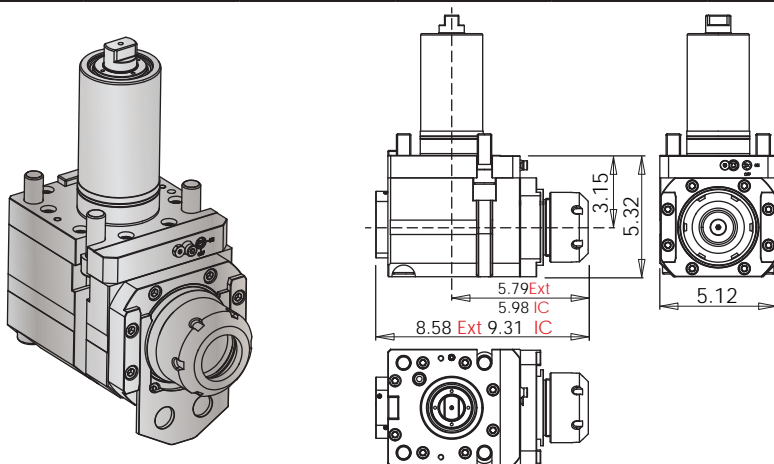

Notes

Wrenches Included with Tools

Maximum Drill Ø		Maximum Mill Ø	
EXT	1 3/8"	EXT	1 3/16"
IC	1 3/8"	IC	1 3/16"

V920 Turret Plugs 14.430.0.0218.0

* 1,450 psi internal coolant (IC) face tool **CAN** be run without coolant; the coolant sealing mechanism can be completely dis-engaged.

All coolant thru live tools require 30 micron coolant filtration nominal, 50 micron coolant filtration absolute.

Tool #	Coolant	Output	Rotation (In:Out)	Mounting Bolts	Max. RPM	Torque	Spindle Wrench	Collet Wrench
14.800.0.0479.0	EXT	ER-50	CW:CW	M16	4,000	100 Nm	1005101050	7111.50000
14.800.0.0478.0	IC & EXT* 1,450 psi	ERC-50	CW:CW	M16	4,000	100 Nm	1005101050	7111.50000

VELOCITY TOOLING FOR OKUMA V760/V920 • 2SP-V760/V920

SU-matic Capto® Tools



V760 / V920 • 2SP-V760 / 2SP-V920 C6 OD-I Holder

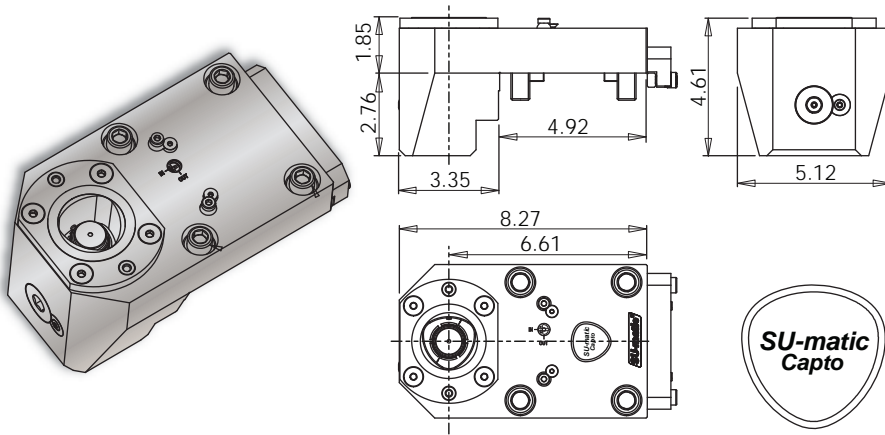

Notes

REGO-FIX® C6 Collet Chucks

ER Output	Rego-Fix Part #
ER-20	2806.12020
ER-25	2806.12520
ER-32	2806.13220
ER-40	2806.14020
V760 Turret Plugs	14.430.0.0194.0
V920 Turret Plugs	14.430.0.0218.0

SU-matic Capto® static tools are coolant thru. Coolant filtration is recommended.

Lathe Model	Tool #	Mounting Bolts	Coolant	Output	Hex Wrench	C6 Collet Chucks
V760 & V920	14.910.0.0415.1	M12 & M16	IC/EXT	C6	12 mm	See Above

V760 / V920 • 2SP-V760 / 2SP-V920 C6 ID Holder

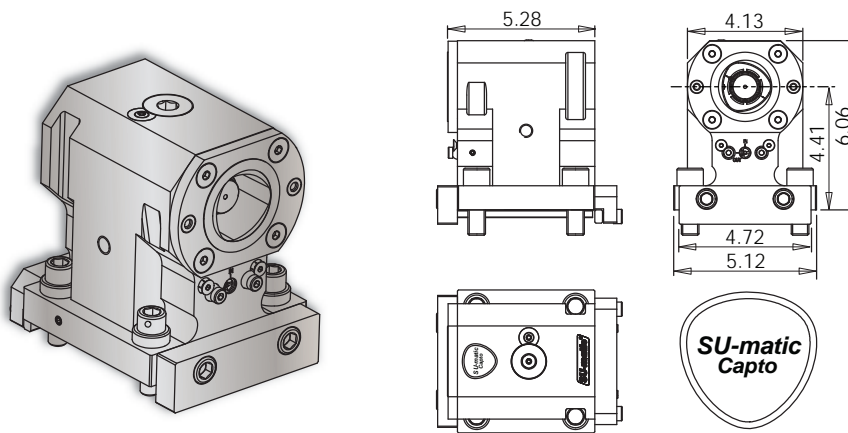

Notes

REGO-FIX® C6 Collet Chucks

ER Output	Rego-Fix Part #
ER-20	2806.12020
ER-25	2806.12520
ER-32	2806.13220
ER-40	2806.14020
V760 Turret Plugs	14.430.0.0194.0
V920 Turret Plugs	14.430.0.0218.0

SU-matic Capto® static tools are coolant thru. Coolant filtration is recommended.

Lathe Model	Tool #	Mounting Bolts	Coolant	Output	Hex Wrench	C6 Collet Chucks
V760 & V920	14.910.0.0416.1	M12 & M16	IC/EXT	C6	12 mm	See Above

SU-matic Capto® Tools



V760 / 2SP-V760 C5 Cross Tool

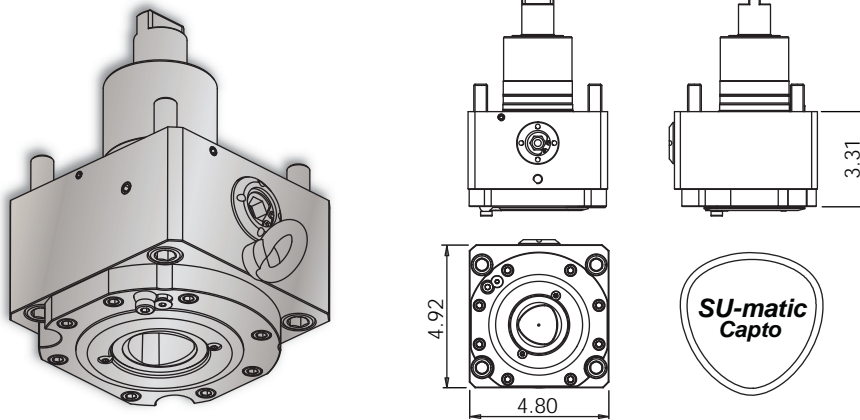

Notes

REGO-FIX® C5 Collet Chucks

ER Output	Rego-Fix Part #
ER-16	4805.11630
ER-20	4805.12010
ER-25	4805.12510
ER-32	4805.13210

Turret Plugs 14.430.0.0194.0

* 1,000 psi internal coolant (IC) cross tool CANNOT be run without coolant.

All coolant thru live tools require 30 micron coolant filtration nominal, 50 micron coolant filtration absolute.

Tool #	Coolant	Output	Rotation (In:Out)	Mounting Bolts	Max. RPM	Torque	Hex Wrench	C5 Collet Chucks
14.101.0.0376.1	IC & EXT* 1,000 psi	C5	CW:CW	M12 & M16	4,000	85 Nm	12 mm	See Above

V760 / 2SP-V760 C5 Face Tool

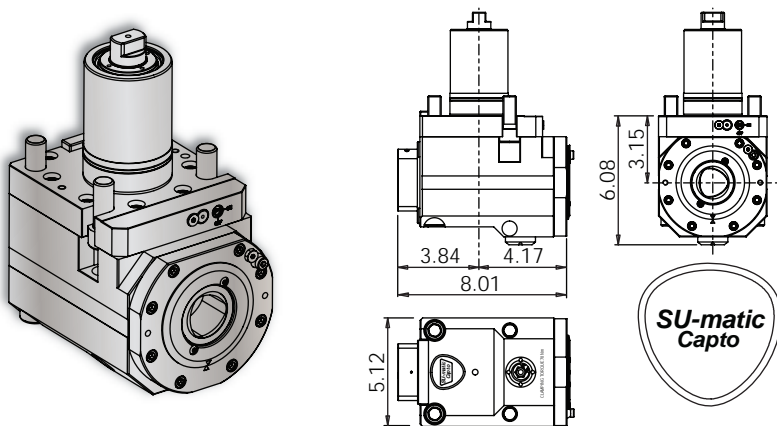

Notes

REGO-FIX® C5 Collet Chucks

ER Output	Rego-Fix Part #
ER-16	4805.11630
ER-20	4805.12010
ER-25	4805.12510
ER-32	4805.13210

Turret Plugs 14.430.0.0194.0

* 1,450 psi internal coolant (IC) face tool CAN be run without coolant; the coolant sealing mechanism can be completely dis-engaged.

All coolant thru live tools require 30 micron coolant filtration nominal, 50 micron coolant filtration absolute.

Tool #	Coolant	Output	Rotation (In:Out)	Mounting Bolts	Max. RPM	Torque	Hex Wrench	C5 Collet Chucks
14.800.0.0490.1	IC & EXT* 1,450 psi	C5	CW:CW	M12 & M16	4,000	85 Nm	12 mm	See Above

VELOCITY TOOLING FOR OKUMA V760/V920•2SP-V760/V920

SU-matic Capto® Tools



V920 / 2SP-V920 C5 Cross Tool

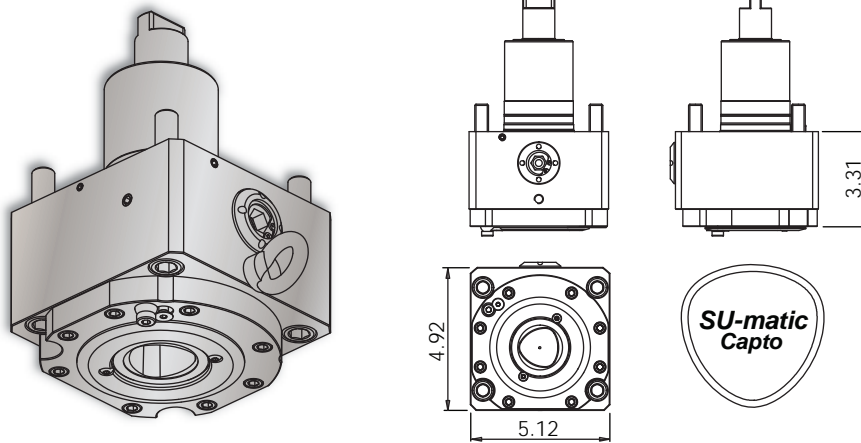

Notes

REGO-FIX® C5 Collet Chucks

ER Output	Rego-Fix Part #
ER-16	4805.11630
ER-20	4805.12010
ER-25	4805.12510
ER-32	4805.13210
Turret Plugs	14.430.0.0218.0

* 1,000 psi internal coolant (IC) cross tool CANNOT be run without coolant.

All coolant thru live tools require 30 micron coolant filtration nominal, 50 micron coolant filtration absolute.

Tool #	Coolant	Output	Rotation (In:Out)	Mounting Bolts	Max. RPM	Torque	Hex Wrench	C5 Collet Chucks
14.101.0.0378.0	IC & EXT* 1,000 psi	C5	CW:CW	M16	4,000	100 Nm	12 mm	See Above

V920 / 2SP-V920 C5 Face Tool

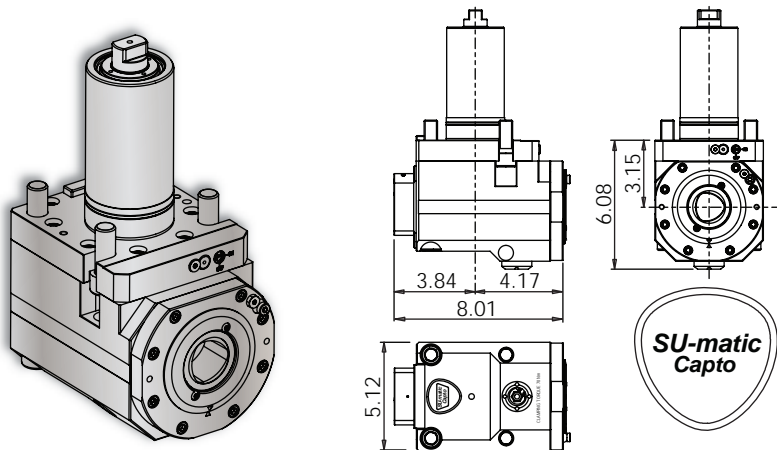

Notes

REGO-FIX® C5 Collet Chucks

ER Output	Rego-Fix Part #
ER-16	4805.11630
ER-20	4805.12010
ER-25	4805.12510
ER-32	4805.13210
Turret Plugs	14.430.0.0218.0

* 1,450 psi internal coolant (IC) face tool CAN be run without coolant; the coolant sealing mechanism can be completely dis-engaged.

All coolant thru live tools require 30 micron coolant filtration nominal, 50 micron coolant filtration absolute.

Tool #	Coolant	Output	Rotation (In:Out)	Mounting Bolts	Max. RPM	Torque	Hex Wrench	C5 Collet Chucks
14.800.0.0488.0	IC & EXT* 1,450 psi	C5	CW:CW	M16	4,000	100 Nm	12 mm	See Above

ONLY FOR
OKUMA

VELOCITY

SU-matic®

V760/V920 • 2SP-V760/V920

www.velocityproducts.com



A Complete Lineup of In-Stock Lathe Tooling for Okuma • Three Year Warranty

Velocity Products • 350 Electronics Boulevard, Huntsville, AL 35824 • 256-258-5549
www.velocityproducts.com • sales@velocityproducts.com

© Velocity Products • Specifications subject to change without notice • Velocity-Okuma V760/V920 & 2SP-V760/920 7.2019.9